

EROSION CONTROL PLAN

SR 1318 Avery County













Porous Baffle Spacing

- *Baffles in Silt Basins at drainage turnouts and all other temporary rock sediment dams—Type B:
- If basin length = 10' or less; 1 baffle
 - If basin length = 11' to 20'; 2 baffles
 - If basin length = 20' or more; 3 baffles
- equally spaced in basin

NOTE: ~~ALL PIPE IS COATED UNLESS NOTED~~

NOTE: PERIMETER EROSION CONTROL MEASURES SHALL BE INSTALLED DURING CLEARING AND GRUBBING PHASE.

NOTE: PLACE TEMPORARY ROCK SEDIMENT DAMS TYPE - B AT DRAINAGE OUTLETS AND TEMPORARY ROCK SILT CHECKS TYPE - A IN DITCHLINE.

Sd. #	Description	Symbol
1605.01	Temporary Silt Fence +/- 1500'	
1606.01	Special Sediment Control Fence	
1622.01	Temporary Berms and Slope Drains	
1630.02	Silt Basin Type B	
1630.05	Temporary Silt Ditch	
1630.05	Temporary Diversion	
1632.05	Rock Inlet Sediment Trap Type C	
1635.01	Temporary Rock Silt Check Type-A	
	Temporary Rock Silt Check Type-B	
	Waffle	
1654.02	Temporary Rock Sediment Dam Type-B	
1655.01	Rock Pipe Inlet Sediment Trap Type-A	

NOTE:
 PERIMETER EROSION CONTROL MEASURES SHALL BE
 INSTALLED DURING CLEARING AND GRUBBING PHASE.

PROJECT:	11C006015/R/W		
	(CONST)		
ROAD:	SR 1318	MCQUIRE RD	
COUNTY:	AVERY COUNTY		
TYPE:	GRADE, DRAIN, BASE, AND PAVE	(0.39 MI)	
SCALE: 1" = 50'	SHEET 1 OF 5	DATE: 1-29-04	

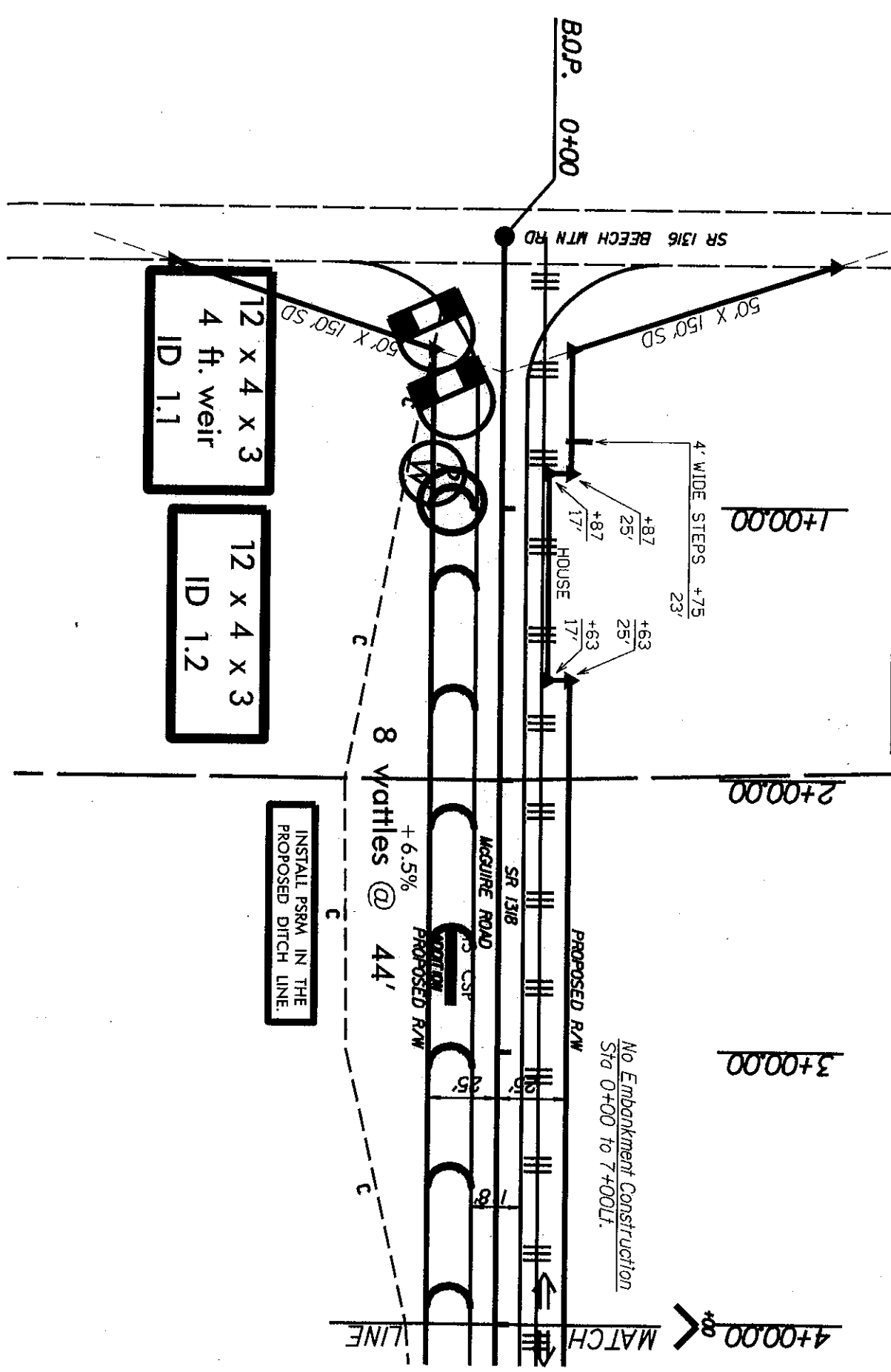

INSTALL PSRM IN THE
 PROPOSED DITCH LINE.

12 x 4 x 3
 4 ft. weir
 ID 1.1

12 x 4 x 3
 ID 1.2

No Embankment Construction
 Sta 0+00 to 7+00L.

1+00.00

2+00.00

3+00.00

4+00.00

B.O.P. 0+00

SR 1316 BEECH MTN RD

50' X 150' SD

4' WIDE STEPS +75
 23'

HOUSE

SR 1318

MCQUIRE ROAD

8 wattles @ 44'

+6.5%

MATCH LINE

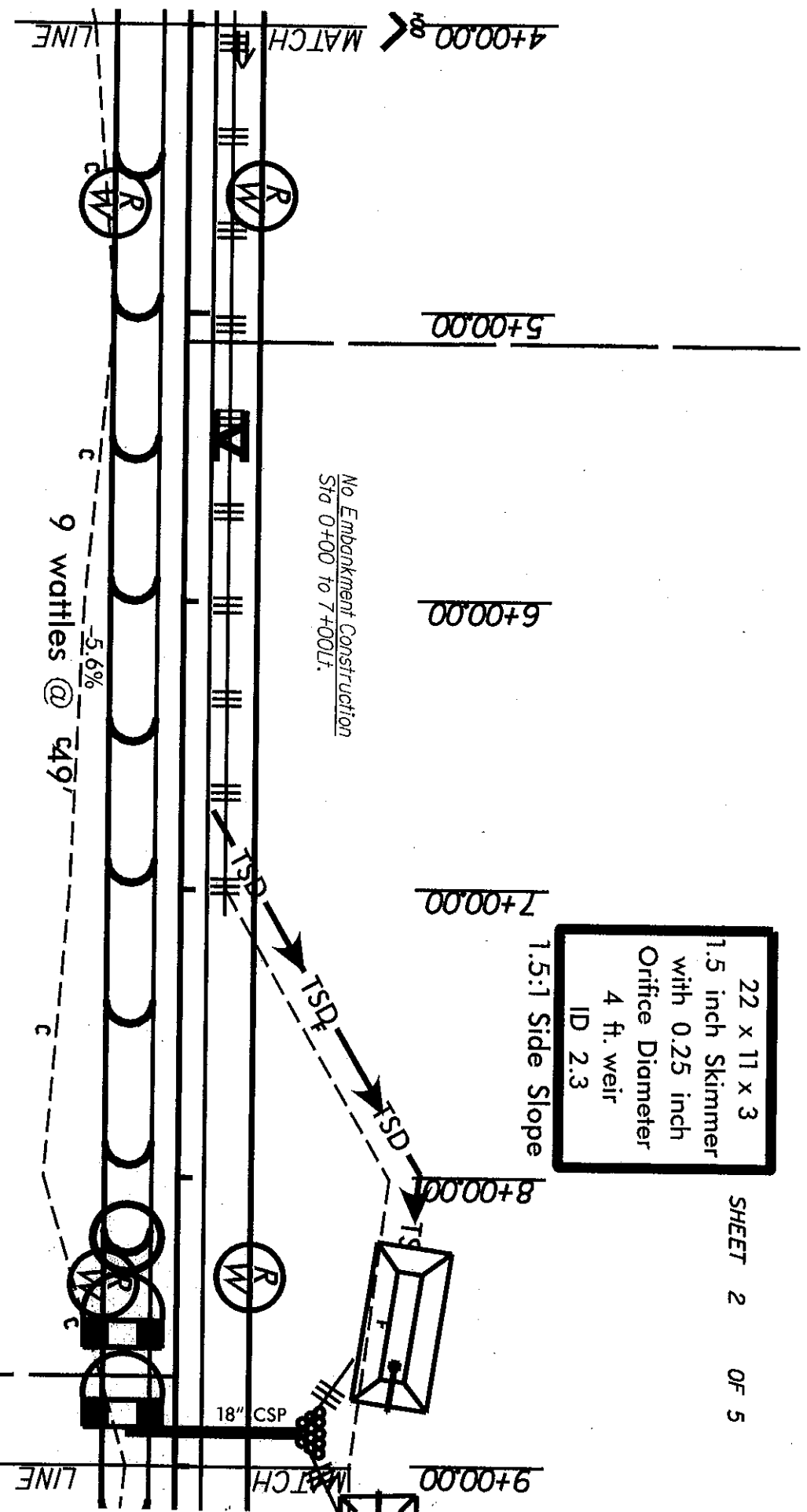

INSTALL PSRM IN THE PROPOSED DITCH LINE.

22 x 11 x 3
1.5 inch Skimmer
with 0.25 inch
Orifice Diameter
4 ft. weir
ID 2.3

9 x 3 x 3
ID 2.2

9 x 3 x 3
2 ft. weir
ID 2.1

22 x 11 x 3
1.5 inch Skimmer
with 0.25 inch
Orifice Diameter
4 ft. weir
ID 3.2

1.5:1 Side Slope

9+00.00
10+00.00
11+00.00
12+00.00
13+00.00
14+00.00

No Embankment Construction
Sta 12+00 to 14+00ft.

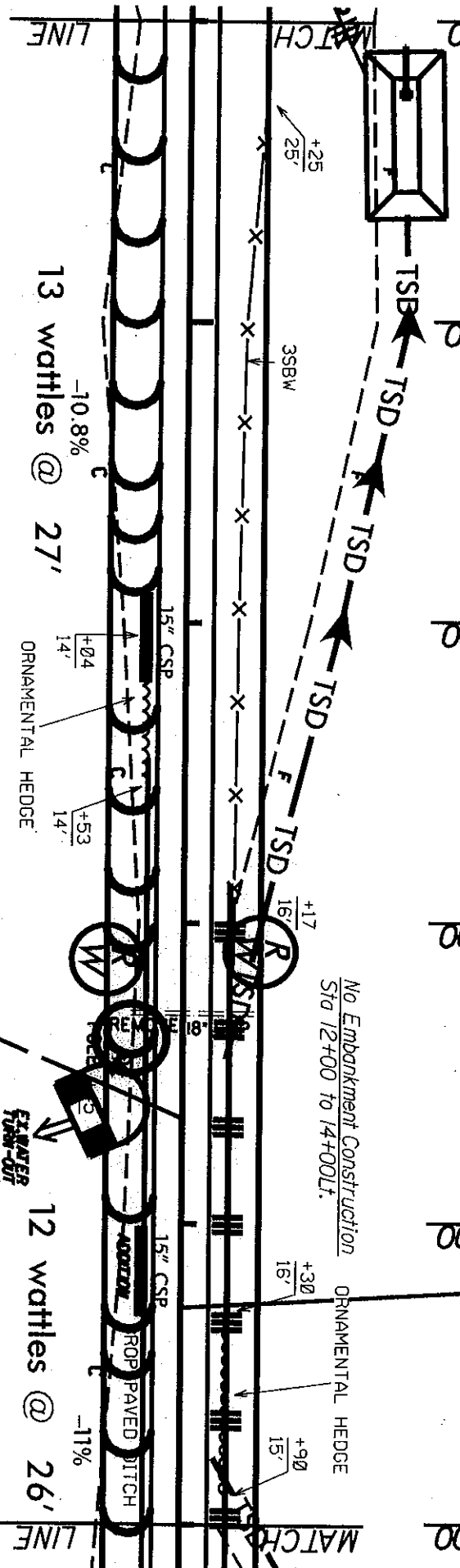

13 wattles @ 27'

-10.8%

15" CSP
ORNAMENTAL HEDGE
14' +04
14' +53

12 wattles @ 26'

-11%

15" CSP
ORNAMENTAL HEDGE
15' +90

PAVED DITCH

INSTALL RIP RAP IN THE
PROPOSED DITCH LINE.

9 x 3 x 3
2 ft. weir
ID 3.1

IP

1.5:1 Side Slope

32 x 16 x 3
4 ft. weir
ID 4.3

14+00.00

15+00.00

16+00.00

17+00.00

18+00.00

19+00.00

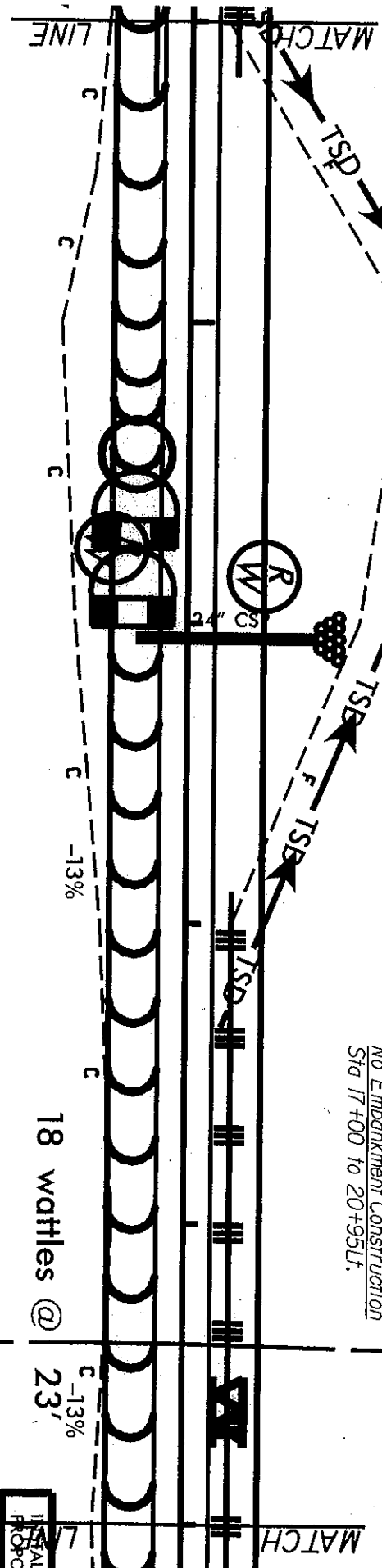

INSTALL RIP RAP IN THE PROPOSED DITCH LINE.

9 x 3 x 3
ID 4.2

9 x 3 x 3
2 ft. weir
ID 4.1

INSTALL RIP RAP IN THE PROPOSED DITCH LINE.

INSTALL RIP RAP IN THE PROPOSED DITCH LINE.

19+00.00

20+00.00

No Embankment Construction
Sta 17+00 to 20+95L.

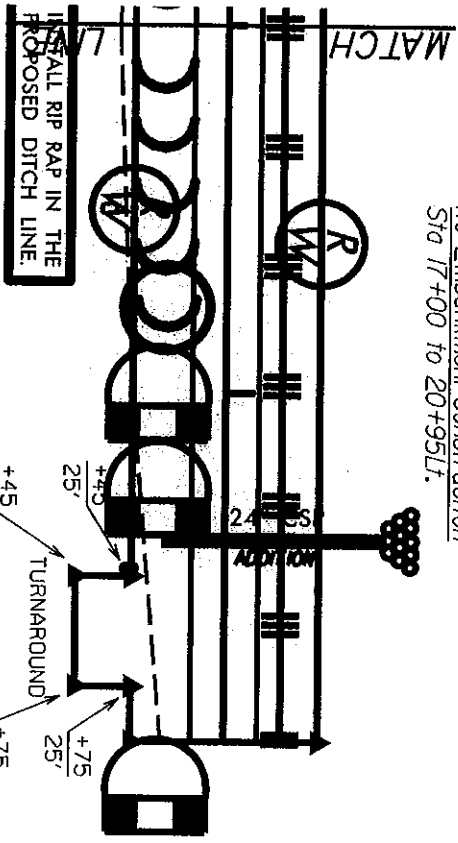

9 x 3 x 3
ID 5.2

12 x 4 x 3
4 ft. weir
ID 5.1

9 x 3 x 3
2 ft. weir
ID 5.3

VICINITY MAP

